

983-D/..-DAM

PCB connector

Screw connection, reinforced side walls, 2 solder pins per pole

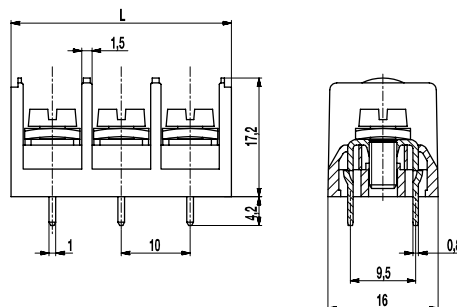

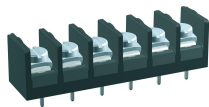

GENERAL INFORMATION

Pitch	10 mm
No. of poles	2 - 6

TECHNICAL DATA

Clamping Range	<i>solid / stranded / AWG</i>		
	0,5 - 2,5 mm ² / 0,5 - 2,5 mm ² / 20 - 12 AWG		
Rated Cross Section	2,5 mm ²		
Wire Stripping Length	8,5 mm ± 0,5 mm		
Overvoltage Category	III	III	II
Pollution Severity Level	3	2	2
Rated Voltage	500 V	630 V	1000 V
Rated Impulse Voltage	6 kV	6 kV	6 kV
Rated Insulation Voltage	750 V acc. to EN 60998-1		
Rated Current	24 A		
Hole in PCB	ø 1,6 mm		
Torque	1,2 Nm		
Other specifications	Per pole two wires of identical cross-section can be connected.		

APPROVALS

	Current [A]	Voltage [V]	Group	AWG	[Nm]
	20	300	B	20 - 12	1,13
	pending				

MATERIAL

Moulding	PA, grey, V-0
Comparative Tracking Index	CTI ≥ 600
Insulating Group	I
Temperature Range	-40°C up to 100°C
Pressure clamp	Tin plated brass
Screw	M4; zinc plated steel, blue passivated
Solder pin	0,8 x 1,0 mm; tin plated brass

OPTIONS / ACCESSORIES

- Consecutive numbering
- Special marking according to drawing
- Self-adhesive marking strip BST-10,00
- Crosshead screws
- 10 mm pin length

CONFIGURATIONS

Poles	Part number	Article number	Length (L)	Packaging	PU
2	983-D/..-DAM/02	20.873.912	22,00 mm	Box	100
3	983-D/..-DAM/03	20.873.913	32,00 mm	Box	100
4	983-D/..-DAM/04	20.873.914	42,00 mm	Box	100
5	983-D/..-DAM/05	20.873.915	52,00 mm	Box	100
6	983-D/..-DAM/06	20.873.916	62,00 mm	Box	100

