

110-A-115

Plug connector
Screw connection, with connecting flanges

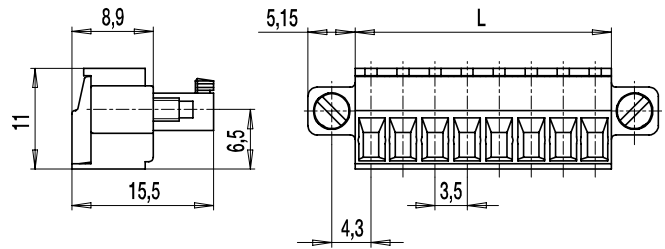

GENERAL INFORMATION

Pitch	3,5 mm
No. of poles	2 - 22
Usable with	all pin strips of series 110 with connecting flanges

TECHNICAL DATA

Clamping Range	<i>solid / stranded / AWG</i>		
	0,14 - 1,5 mm ² / 0,14 - 1,5 mm ² / 28 - 16 AWG		
Rated Cross Section	1,5 mm ²		
Wire Stripping Length	6,5 mm ± 0,5 mm		
Overvoltage Category	III	III	II
Pollution Severity Level	3	2	2
Rated Voltage	160 V	160 V	320 V
Rated Impulse Voltage	2,5 kV	2,5 kV	2,5 kV
Rated Insulation Voltage	130 V acc. to EN 60998-1		
Rated Current	8 A		
Torque	0,2 Nm		

APPROVALS

	Current [A]	Voltage [V]	Group	AWG	[Nm]
	8	300	B, D	30 - 16	0,2
	8	300	B	30 - 16	0,2

MATERIAL

Moulding	PA, grey, V-0
Comparative Tracking Index	CTI ≥ 600
Insulating Group	I
Temperature Range	-40°C up to 100°C
Terminal body	Nickel plated brass
Pressure clamp	Tin plated tin bronze
Screw	M2; tin plated tin bronze
Spring	Tin plated tin bronze

OPTIONS / ACCESSORIES

- Consecutive numbering
- Special marking according to drawing
- Self-adhesive marking strip BST-3,50
- Pitch of 7 mm for larger clearance and creepage distances
- Strain relief

CONFIGURATIONS

Poles	Item	Article number	Length (L)	Packaging	PU
2	110-A-115/02	15.840.077	7,00 mm	Box	100
3	110-A-115/03	15.840.078	10,50 mm	Box	100
4	110-A-115/04	15.840.079	14,00 mm	Box	100
5	110-A-115/05	15.840.080	17,50 mm	Box	50
6	110-A-115/06	15.840.081	21,00 mm	Box	50
7	110-A-115/07	15.840.082	24,50 mm	Box	50
8	110-A-115/08	15.840.083	28,00 mm	Box	50
9	110-A-115/09	15.840.084	31,50 mm	Box	50
10	110-A-115/10	15.840.085	35,00 mm	Box	50
11	110-A-115/11	15.840.086	38,50 mm	Box	50
12	110-A-115/12	15.840.087	42,00 mm	Box	50

further number of poles on request

