

140-A-111-THR

PCB connector for THR

Screw connection, short solder pins

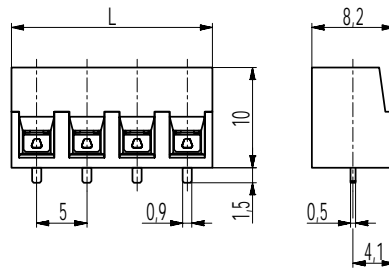

RECOMMENDED PCB LAYOUT

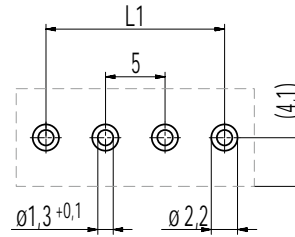

L1 = (No. of poles - 1) x pitch
 Solder pad diameter: \varnothing 2,2 mm
 Solder paste thickness: 0,15 - 0,2 mm

GENERAL INFORMATION

Pitch	5 mm
No. of poles	2 - 12

TECHNICAL DATA

Clamping Range	<i>solid / stranded / AWG</i> 0,14 - 2,5 mm ² / 0,14 - 1,5 mm ² / 26 - 16 AWG		
Rated Cross Section	1,5 mm ²		
Wire Stripping Length	6 mm \pm 0,5 mm		
Overvoltage Category	III	III	II
Pollution Severity Level	3	2	2
Rated Voltage	200 V	320 V	500 V
Rated Impulse Voltage	4 kV	4 kV	4 kV
Rated Insulation Voltage	250 V acc. to EN 60998-1		
Rated Current	16 A		
Soldering process	Reflow solder		
Hole in PCB	\varnothing 1,3 mm		
PCB thickness	1,6 mm		
Torque	0,5 Nm		

MATERIAL

Moulding	PA HT, black, V-0
Comparative Tracking Index	CTI \geq 600
Insulating Group	I
Temperature Range	-40°C up to 120°C; reflow solder temperature peak max. 255°C acc. to DIN EN 61760-1
Terminal body	Nickel plated brass
Pressure clamp	Tin plated copper alloy
Screw	M3; Zinc plated steel, blue passivated
Solder pin	0,9 x 0,5 mm; tin plated copper alloy

OPTIONS / ACCESSORIES

- Consecutive numbering
- Special marking according to drawing
- Self-adhesive marking strip BST-5,00 [1]
- Pitch of 10 mm for larger clearance and creepage distances
- Tape-on-Reel on request
- Other solder pin lengths on request

[1] To be fitted after reflow soldering process

CONFIGURATIONS

Poles	Item	Article number	Length (L)	Packaging	PU	Tape Width	Tape Height
2	140-A-111-THR/02	10.801.562	10,00 mm	Box	250		
3	140-A-111-THR/03	10.801.563	15,00 mm	Box	250		
4	140-A-111-THR/04	10.801.564	20,00 mm	Box	200		
5	140-A-111-THR/05	10.801.565	25,00 mm	Box	100		
6	140-A-111-THR/06	10.801.566	30,00 mm	Box	100		
2	140-A-111-THR/02-T&R	10.801.562.A00	10,00 mm	Tape-on-Reel	400	24 mm	13 mm

further number of poles on request

