

971-X..(-DS)

PCB connector

Screw connection, wire entrance vertical to PCB, 2 to 12 screw connections at only one pole

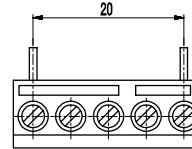
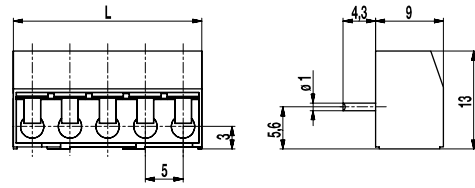

GENERAL INFORMATION

Pitch	5 mm
No. of poles	1

TECHNICAL DATA

Clamping Range	solid / stranded / AWG		
without wire protector	1 - 6 mm ² / 1 - 2,5 mm ² / 16 - 12 AWG		
with wire protector	0,75 - 4 mm ² / 0,75 - 2,5 mm ² / 18 - 12 AWG		
Rated Cross Section	2,5 mm ²		
Wire Stripping Length	6,5 mm ± 0,5 mm		
Overvoltage Category	III	III	II
Pollution Severity Level	3	2	2
Rated Voltage	250 V	320 V	630 V
Rated Impulse Voltage	4 kV	4 kV	4 kV
Rated Current	24 A		
Hole in PCB	ø 1,3 mm		
Torque	0,5 Nm		

APPROVALS

	Current [A]	Voltage [V]	Group	AWG	[Nm]
	20	300	B	26 - 12	0,51
	10	300	D, E	26 - 12	0,51

MATERIAL

Moulding	PA, grey, V-0
Comparative Tracking Index	CTI ≥ 600
Insulating Group	I
Temperature Range	-40°C up to 100°C
Terminal body	Tin plated brass
Screw	M3; zinc plated steel, blue passivated
Solder pin	ø 1 mm; tin plated copper
Wire protector	Tin plated tin bronze

OPTIONS / ACCESSORIES

- Marking according to customer requirement
- Self-adhesive marking strip BST-5,00
- Other solder pin lengths on request
- Solder pins with different lengths between each other
- Other position of solder pins
- Version with extended wire entrance

CONFIGURATIONS

Poles	Item	Article number	Item	Article number	Length (L)	Packaging	PU
5	971-X5/01	10.872.555	971-X5-DS/01	20.872.555	25,00 mm	Box	100
6	971-X6/01	10.872.556	971-X6-DS/01	20.872.556	30,00 mm	Box	100
7	971-X7/01	10.872.557	971-X7-DS/01	20.872.557	35,00 mm	Box	100
8	971-X8/01	10.872.558	971-X8-DS/01	20.872.558	40,00 mm	Box	100
9	971-X9/01	10.872.559	971-X9-DS/01	20.872.559	45,00 mm	Box	100
10	971-X10/01	10.872.560	971-X10-DS/01	20.872.560	50,00 mm	Box	100
11	971-X11/01	10.872.561	971-X11-DS/01	20.872.561	55,00 mm	Box	100
12	971-X12/01	10.872.562	971-X12-DS/01	20.872.562	60,00 mm	Box	100

further number of poles on request

