

983-SML-2,8

PCB connector
Screw connection, with solder pin and solder tag

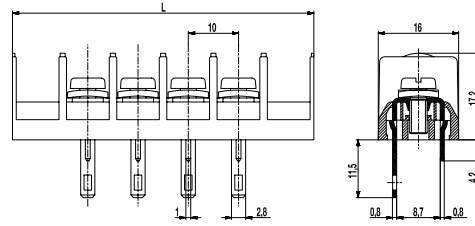
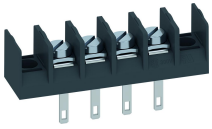

GENERAL INFORMATION

Pitch	10 mm
No. of poles	1 - 12

TECHNICAL DATA

Clamping Range	<i>solid / stranded / AWG</i>
	0,5 - 2,5 mm ² / 0,5 - 2,5 mm ² / 20 - 12 AWG
Rated Cross Section	2,5 mm ²
Wire Stripping Length	8,5 mm
Overvoltage Category	III
Pollution Severity Level	3
Rated Voltage	320 V
Rated Impulse Voltage	4 kV
Rated Insulation Voltage	450 V acc. to EN 60998-1
Rated Current	17,5 A (wire 1.5 mm ² in soldering tag area)
Hole in PCB	ø 1,6 mm
Torque	1,2 Nm
Other specifications	Fixing holes ø 3,2 mm. Per pole two wires of identical cross-section can be connected.

APPROVALS

	Current [A]	Voltage [V]	Group	AWG	[Nm]
	20	300	B	20 - 12	1,13
	20	300	B	20 - 12	1,13
	10	300	D, E	20 - 12	1,13

CONFIGURATIONS

Poles	Part number	Article number	Length (L)	Packaging	PU
1	983-SML-2,8/01	94.873.803	30,00 mm	Box	100
2	983-SML-2,8/02	94.873.804	40,00 mm	Box	100
3	983-SML-2,8/03	94.873.805	50,00 mm	Box	100
4	983-SML-2,8/04	94.873.806	60,00 mm	Box	100
5	983-SML-2,8/05	94.873.807	70,00 mm	Box	100
6	983-SML-2,8/06	94.873.808	80,00 mm	Box	100

MATERIAL

Moulding	PA, grey, V-0
Comparative Tracking Index	CTI ≥ 600
Insulating Group	I
Temperature Range	-40°C up to 100°C
Pressure clamp	Tin plated brass
Screw	M4; zinc plated steel, blue passivated
Solder pin	0,8 x 1,0 mm; tin plated brass

OPTIONS / ACCESSORIES

- Consecutive numbering
- Special marking according to drawing
- Self-adhesive marking strip BST-10,00
- Fastening pole position can be freely selected
- Crosshead screws
- Various tab versions available instead of screw connections

